



What Can the PF Advantage Do For You?

- **Direct Drive The Rawson Accu-Rate Drive**
- **Yield & Moisture Monitoring and Mapping**
- **Site Verification Mapping**
- **Application Control with Prescription Maps**
- **Guidance with optional Lightbar**
- **Create and display Field Boundary Maps**
- **Gridding & Soil Sampling**
- **Navigate to Any Location**
- **On-Screen Coverage Maps**

Yield Monitoring and Mapping

The *PF Advantage* yield monitor or mapping system is the tool you need to start making profit-making decisions in the field and back at the office.

Display four items at once such as yield, moisture, area and weight or bushels. Observe moisture readings while harvesting and decide which grain should be hauled to the dryer without stopping the combine. The savings in drying costs can more than pay for the system in one year. Keep the combine operating at full capacity by watching grain flow in bushels per hour.

Add a memory card and GPS receiver and the *PF Advantage* becomes a yield mapping system that provides you with invaluable yield map data. This data can be used to evaluate hybrids, chemicals, fertilizer rates and tillage practices. It can also help identify crop management zones for creating prescription maps.

Whether you are yield monitoring or mapping, the *PF Advantage* records your data into fields and loads. At the end of the season, easily print out the average yield and moisture, total area, wet and dry bushels for each field and load.

Direct Drive Accu-Rate Hydraulic Drives

The *PF Advantage* directly controls the Rawson Accu-Rate hydraulic without the Accu-Rate console. Save money by purchasing an Accu-Rate drive system without the Accu-Rate console.

The *PF Advantage* sets the hydraulic drive RPM based on ground speed, swath and specified planting or fertilizing rate. The rate is set manually by the operator or automatically from a prescription file on a memory card for variable rate control.

Use the *PF Advantage* and Accu-Rate to control planting rates and dry or liquid fertilizer rates on pull type applicators.

Available With or Without GPS

The *PF Advantage* is available with the All-In-The-Antenna designed GPS 1000 Plus or EZ-Guide Plus.

The optional Ag Leader EZ-Guide Plus easily connects to the *PF Advantage* for accurate straight-line or contour parallel swathing. The GPS 1000 Plus is not available for guidance.

Eliminate costly skips and overlaps when you apply chemicals or fertilizer. The EZ-Guide Plus is even useful for harvesting. Instead of straining to see the edge of wide cutting platforms at night or in dusty conditions, drive by the Lightbar.

With the *PF Advantage*'s on screen map, you can view a coverage map, application map, navigation map or guidance map that is based on the swath of your implement.

Features

PFadvantage Features

- Direct drive of Rawson Accu-Rate drive
- Grain yield monitoring & cotton yield monitoring - with or without GPS
- Bulk crop yield monitoring with Harvestmaster™ 500 or 570.
- 20% more processor speed and 300% more working memory than the PF3000
- Site verification - record locations of different hybrids, fertilizers, or chemicals.
- As-applied mapping - record actual application rates.
- Application control - vary application rate through prescriptions written to a memory card.
- Gridding for soil sampling - load in pre-recorded grids or create grids in the field using field boundary maps.
- Navigation - guides the operator to gridded or manually entered points.
- Large graphics display with the ability to view four on-the-go values at once.
- On screen map – view swath based coverage map, boundary map or to-be-applied target rate map.
- Easy operation through clear on-screen messages.
- Built-in field marking capability of 4 user-definable marks
- Plug compatible with PF3000 for an easy, low-cost upgrade path
- Automatic memory backup for data security
- Upgradeable through serial port or memory card
- 2-Year Warranty

GPS models available

- GPS 1000 Plus
 - Inexpensive yield mapping & Site Verification
 - Differential - WAAS only
- EZ-Guide Plus
 - Lightbar capable
 - Recommended for variable rate application
 - Differential - WAAS only

PFadvantage with Rawson Accu-Rate Controller Schematic

Accu-Rate drive and cabling (Items 1-7 on diagram) are available through Rawson Control Systems.

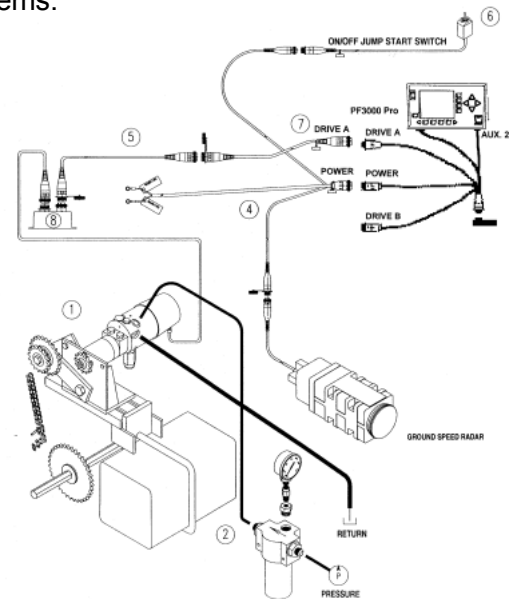

Single Drive System Shown – Available in Single, Double & Triple Drive Systems

For more information see our web site at:

www.agleader.com

or contact:

Rawson Control Systems
116 2nd St. NE, Olweil, IA 50662
1-888-729-7667

www.rawsoncontrol.com/

Ag Leader Technology, Inc.
2202 South Riverside Drive
Ames, IA 50010
515-232-5363
Internet: <http://www.agleader.com>